

22/9

Notice of hearing of representations in respect of an application for an existing licence to be converted to a premises licence under the Licensing Act 2003 and (Part B) application to vary the premises licence simultaneously

To Lancashire Police
Of
(objector)

The Chorley Borough Council being the licensing authority, on the 5th August 2005 received an application to convert and vary the Justices Licence from J Gaunt on behalf of The Black Horse Heath Charnock Chorley

The Council have received representations from the Police on the likely effect of the Grant to Vary the Premises Licence on the promotion of the Licensing Objectives.

The Council now GIVES YOU NOTICE that representations will be considered at a hearing to be held at Chorley Borough Council Town Hall

On 11th October 2005 at 2pm following which the Council will issue a Notice of Determination of the Application.

[The documents which accompany this notice are the relevant representations which have been made, as defined in Section 35(5) of the Act.] – To Follow

The particular points on which the Council considers that it will want clarification at the hearing from the applicant are as follows:

- Licensing objectives:- The prevention of Public Nuisance
- The Prevention of Crime and Disorder
- Protection of Children from Harm

For the applicant to describe any additional steps that he/she intends to make in promoting the above licensing objective

For the objector to describe the likely effect of the grant of the premises licence on promoting the above licensing objective

You should complete the enclosed form and return it to:

Mr H. Bee, The Licensing Manager, Licensing Department, Civic Buildings, Union Street, Chorley, Lancs. PR7 1AL.

within five (5) working days before the day or the first day on which the hearing is to be held.

Date _____ Signed _____

Designation _____
the officer appointed for this purpose

Notes:

LICENSING ACT 2003

Right of attendance assistance and representation

- 15 Subject to regulations 14(2) and 25, a party may attend the hearing and may be assisted or represented by any person whether or not that person is legally qualified.

Representations and supporting information

- 16 At the hearing a party shall be entitled to-
- (a) in response to a point upon which the authority has given notice to a party that it will want clarification under regulation 7(1)(d), give further information in support of their application, representations or notice (as applicable),
 - (b) if given permission by the authority, question any other party; and
 - (c) address the authority.

Failure of parties to attend the hearing

- 20 -
- (1) If a party has informed the authority that he does not intend to attend or be represented at a hearing, the hearing may proceed in his absence.
 - (2) If a party who has not so indicated fails to attend or be represented at a hearing the authority may -
 - (a) where it considers it to be necessary in the public interest, adjourn the hearing to a specified date, or
 - (b) hold the hearing in the party's absence
 - (3) Where the authority holds the hearing in the absence of a party, the authority shall consider at the hearing the application, representations or notice made by that party.
 - (4) Where the authority adjourns the hearing to a specified date it must forthwith notify the parties of the date, time and place to which the hearing has been adjourned.

Procedure at hearing

- 21 Subject to the provisions of the Regulations, the authority shall determine the procedure to be followed at the hearing.
- 22 At the beginning of the hearing, the authority shall explain to the parties the procedure which it proposes to follow at the hearing and shall consider any request made by a party under regulation 8(2) for permission for another person to appear at the hearing, such permission shall not be unreasonably withheld.
- 23 A hearing shall take the form of a discussion led by the authority and cross-examination shall not be permitted unless the authority considers that cross-examination is required for it to consider the representations, application or notice as the case may require.
- 24 The authority must allow the parties an equal maximum period of time in which to exercise their rights provided for a regulation 16.
- 25 The authority may require any person attending the hearing who in their opinion is behaving in a disruptive manner to leave the hearing and may —
- (a) refuse to permit that person to return, or
 - (c) permit him to return only on such conditions as the authority may specify,
- but such a person may, before the end of the hearing, submit to the authority in writing any information which they would have been entitled to give orally had they not been required to leave.

Lancashire Constabulary

Licensing Unit, Police Station, St Thomas's Road, Chorley, PR7 1DR

Tel: 01257 246215

Fax: 01257 246217

e-mail: southern-licensing@lancashire.pnn.police.uk

05 August 2005

Licensing Officer
Chorley Borough Council
Town Hall
Market Street
Chorley
PR7 1DP

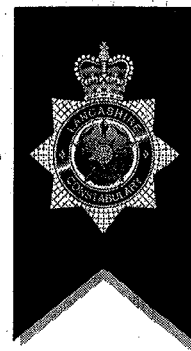

Dear Sir

RE: PREMISES LICENCE REPLY:- LICENSING ACT 2003 - REF Variation.

Premises BLACK HORSE, LONG LANE, HEATH CHARNOCK

There are the following police representations to be made in respect of this application:-

1. The Police are concerned regarding B, C, E, F, G, and M on the form. We feel that the latest time for any amplified entertainment should be no later than 0000 hrs to prevent crime and disorder, the prevention of public nuisance and the protection of children from harm. Entertainment allowed an extra hour at New Year AND OTHER 12 AGREED SPECIAL OCCASIONS, recorded music could generally continue until 0100 but between 0000 and 0100 as background music ONLY at a reduced volume, this would have to be stipulated.
2. We feel for the local area and the fact many customers must drive to the premises the LATEST sale of alcohol should be 0000, with a suggested 1 hr drinking up time, later at New Year.

Yours faithfully

Police Sergeant 1506

(Licensing)

**JOHN GAUNT
&
PARTNERS**

Our Ref: AMW/TIL/15924
Contact: Ash Wall
Tel: 0114 266 3400

Chorley Borough Council
Licensing Officer
Town Hall
Market Street
Chorley
Lancashire
PR7 1DP

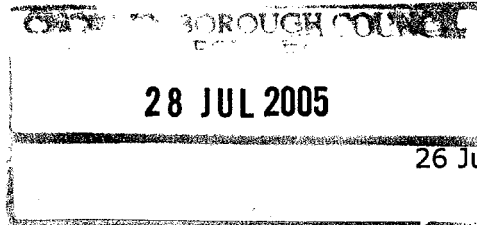

Dear Sirs

Premises – Black Horse, Long Lane, Heath Charnock, Chorley, PR6 9EE
Applicant – Timothy Graham Sleeman, ,

We act for Trust Inns Limited and Timothy Graham Sleeman.

On our client's behalf, we enclose by way of service on you Notice of Application for the grant of a Premises Licence for Black Horse together with our cheque in your favour in the sum of £250.00 being the fee payable. Kindly acknowledge safe receipt.

In support of the application, we enclose a plan of the premises, the consent of the proposed DPS and the consents of the current licensee and originals or certified copies of the following documents:

Justices on Licence
AWP Permit

The plans identify the licensed area edged in red. For the purpose of clarification we confirm that all proposed licensable activities extend to the public areas within this area.

We confirm that we have served copies of the enclosed application and supporting documents on the relevant authorities being the Police, Fire Authority, Local Enforcement of Health & Safety at work, Environmental Health Authority, Planning Authority, the relevant authority for Protection of Children from Harm and Weights and Measures.

You may have already received, or you should shortly receive, the application for the Personal Licence for the designed Premises Supervisor and any other related Personal Licence application to these premises.

The enclosed application comprises an application for conversion and variation. The variation proposed is detailed at part B1. It is not the intention of this application to alter the nature of the operation at these premises.

Omega Court 372 Cemetery Road Sheffield S11 8FT
Telephone: 0114 266 8664 (Main) 0114 266 3400 (Reform)
Email: post@john-gaunt.co.uk Fax: 0114 266 0101 DX: 717212 Sheffield 27

Web: www.john-gaunt.co.uk www.licensing-reform.co.uk

Partners: John Gaunt Katharine Redford Tim Shield Michelle Hazlewood
Associates: David Hollis Craig Burman Practice Manager: Susie Glossop

glass - the **gaunt** licence application **support** service for reform

Solicitors Regulated by the Law Society



INVESTOR IN PEOPLE

Please note that if the variation of hours requested at B1 paragraph 4 is granted, that variation sought at paragraph 2 may become redundant.

Should you have any queries, please do not hesitate to telephone us. Please quote our reference on all correspondence.

Thank you for your assistance.

Yours faithfully

A handwritten signature in black ink, appearing to be 'John Gaunt', written over the typed name.

John Gaunt & Partners
Email: aisling@john-gaunt.co.uk

Information on plans

Plans of the premises must accompany the application and unless the relevant Licensing Authority has previously agreed in writing with the applicant following request that an alternative scale is acceptable to it, the plans should be drawn on a standard scale (1:100).

Under the Licensing Act 2003 (Schedule 8 Paragraph 2 (6)(b)), the plan is required to be in the specified form (in accordance with the Regulations), of the premises to which the relevant existing licence or licences relate - unless, therefore, any of the existing (current) Licences specifically licence any external area, no external areas need to be shown on the plans, a view to which the DCMS appears to agree.

The plans identify the licensed area edged in red. For the purpose of clarification we confirm that all proposed licensable activities extend to the public areas within this area.

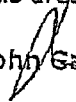
 John Gaunt & Partners

March 2005

Omega Court 372 Cemetery Road Sheffield S11 8
Telephone: 0114 266 8664 (Main) 0114 266 3400 (Refr)
Email: post@john-gaunt.co.uk Fax: 0114 266 0101 DX: 717212 Sheffield

Web: www.john-gaunt.co.uk www.licensing-reform.co

Partners: John Gaunt Katharine Redford Tim Shield Michelle Hazlewood
Associates: David Hollis Craig Burman Practice Manager: Susie Gloss

glass - the gaunt licence application support service for refr

Not a Law Firm Regulated by the Law Society



(Part A) Application for an existing licence to be converted to a premises licence under the Licensing Act 2003 and (Part B) application to vary the premises licence simultaneously

PLEASE READ THE FOLLOWING INSTRUCTIONS FIRST

Before completing this form please read the guidance notes at the end of the form.
If you are completing this form by hand please write legibly in block capitals. In all cases ensure that your answers are inside the boxes and written in black ink. Use additional sheets if necessary.
You may wish to keep a copy of the completed form for your records.

I Timothy Graham Sleeman, apply to convert an existing licence to a premises licence under Schedule 8 to the Licensing Act 2003 for the premises described in Part A1 below

Part A1 – Premises Details

Postal address of premises or, if none, ordnance survey map reference or description	
Black Horse, Long Lane, Heath Charnock, Chorley	
Post town Chorley	Post code PR6 9EE

Telephone number of premises (if any)

01257 264 030

Non-domestic rateable value of premises

£9150

Part A2 - Applicant Details

Please state the capacity in which you are applying to convert your existing licence

Please tick ✓

- a) An individual or individuals please complete section (A)
- b) a person other than an individual
- i. as a limited company please complete section (B)
 - ii. as a partnership please complete section (B)
 - iii. as an unincorporated association or please complete section (B)
 - iv. other (for example a statutory corporation) please complete section (B)
- c) a recognised club please complete section (B)
- d) a charity please complete section (B)
- e) the proprietor of an educational establishment please complete section (B)
- f) a health service body please complete section (B)
- g) a person who is registered under Part 2 of the Care Standards Act 2000 (c14) in respect of an independent hospital please complete section (B)
- h) the chief officer of police of a police force in England and Wales please complete section (B)

APPLICATION N^o: 004556

(A) INDIVIDUAL APPLICANTS (fill in as applicable)

Mr Mrs Miss Ms Other title (For example, Rev)

Surname
Sleeman

First names
Timothy Graham

I am 18 years old or over Please tick

Current postal address if different from premises address Black Horse, Black Horse, Long Lane, Heath Charnock

Post Town Chorley Postcode PR6 9EE

Daytime contact telephone number

Email address (optional)

Second Individual Applicant (if applicable)

Mr Mrs Miss Ms Other title (For example, Rev)

Surname

First names

I am 18 years old or over Please tick

Current postal address if different from premises address

Post Town Postcode

Daytime contact telephone number

Email address (optional)

(B) OTHER APPLICANTS

Please provide name and registered address of applicant in full. Where appropriate please give any registered number. In case of a partnership or other joint nature (other than a body corporate), please give the name and address of each party concerned.

Name
Address
Registered number (where applicable)
Description of applicant (for example, partnership, company, unincorporated association etc.)
Telephone number (if any)
E-mail address (optional)

Part A3 - Operating Schedule

If 5000 or more people attend the premises at any one time please state the number

N/A

General description of premises (please read guidance note 1)

Established public house with food trade as identified on the deposited plans and also with rights to provide "regulated entertainment" inherent in LA 1964.

These premises are entitled to sell to residents and supply their bona fide guests 24 hours a day pursuant to section 63(2) LA 1964.

These premises are entitled to provide private entertainment.

2 AWP Machines under s.34 Gaming Act 1968 Permit

The premises have an existing external area available to patrons for consumption of off supplies.

What existing licensable activities are authorised by your existing licence(s)?

Provision of regulated entertainment

- a) plays
- b) films
- c) indoor sporting events
- d) boxing or wrestling entertainment
- e) live music
- f) recorded music
- g) performances of dance
- h) anything of a similar description to that falling within (e), (f) or (g)

Handwritten initials

Provision of entertainment facilities for:

- i) making music
- j) dancing
- k) entertainment of a similar description to that falling within (i) or (j)

Provision of late night refreshment

Sale by retail of alcohol

- a) for consumption on the premises
- b) for consumption off the premises

Please state who you wish to be specified to be the premises supervisor under the new licence

Name: Timothy Graham Sleeman.....

Address: Black Horse, Long Lane, Heath Charnock, Chorley, PR6 9EE.....

Personal Licence number, if known: Not Known.....

State any limitations on the hours during which you are permitted by your licence(s) or any additional authorities to conduct licensable activities, including the sale of alcohol.

Permitted licensing hours apply for on and off sales

Monday to Saturday: 11:00 - 23:00

Sundays and Good Friday: 12:00 - 22:30

New Years Eve: 11:00 - New Years Day - terminal hour as existing

Christmas Day: 12:00 - 15:00 and 19:00 - 22:30

Describe the conditions subject to which your existing licence(s) has/have been granted (please read guidance note 2):

a) General - all four licensing objectives (b,c,d,e)

Only such conditions and restrictions as are inherent in the Licensing Act 1964

b) The prevention of crime and disorder

See (a) above

c) Public safety

See (a) above

d) The prevention of public nuisance

See (a) above

e) The protection of children from harm

See (a) above

- | | Please tick | Yes |
|---|-------------|-------------------------------------|
| ▪ I have made or enclosed payment of the fee | | <input checked="" type="checkbox"/> |
| ▪ I have enclosed my existing licence(s) or a certified copy of each licence | | <input checked="" type="checkbox"/> |
| ▪ I have enclosed a plan of the premises | | <input checked="" type="checkbox"/> |
| ▪ I have sent copies of this application to the chief officer of police (please read guidance note 3) | | <input checked="" type="checkbox"/> |
| ▪ I have enclosed the consent form completed by the proposed premises supervisor, if relevant | | <input checked="" type="checkbox"/> |
| ▪ I have enclosed the consent of the justices' licence holder to my application, if relevant | | <input checked="" type="checkbox"/> |
| ▪ I understand that if I do not comply with the above requirements my application will be rejected | | <input checked="" type="checkbox"/> |

IT IS AN OFFENCE, LIABLE ON CONVICTION TO A FINE UP TO LEVEL 5 ON THE STANDARD SCALE £5000, UNDER SECTION 158 OF THE LICENSING ACT 2003 TO MAKE A FALSE STATEMENT IN OR IN CONNECTION WITH THIS APPLICATION

Part A4 – Signatures (please read guidance note 4)

Signature of applicant or applicant's solicitor or other duly authorised agent. (Please read guidance note 5). **If signing on behalf of the applicant please state in what capacity.**

Signature: John Gaunt & Partners

Date: 26th July 2005

Capacity: Solicitors.....

For joint applications signature of 2nd applicant or 2nd applicant's solicitor or other authorised agent. (Please read guidance note 6). **If signing on behalf of the applicant please state in what capacity.**

Signature:

Date:

Capacity.....

Contact name (where not previously given) and address for correspondence associated with this application (please read guidance note 7) John Gaunt and Partners Solicitors 372 Omega Court Cemetery Road	
Post town Sheffield	Post code S11 8FT
Telephone number 0114 266 3400	DX 717212 Sheffield 27
E-mail address (optional) aisling@john-gaunt.co.uk	

IF YOU WISH TO APPLY SIMULTANEOUSLY FOR A VARIATION OF THE PREMISES LICENCE IF IT IS CONVERTED FROM YOUR EXISTING LICENCE(S) UNDER SECTION 34 OR 37 OF THE LICENSING ACT 2003, NOW COMPLETE PART B OF THIS FORM.

IF YOU DO NOT WISH TO APPLY SIMULTANEOUSLY FOR A VARIATION OF THE PREMISES LICENCE IF IT IS CONVERTED FROM YOUR EXISTING LICENCE(S), YOU SHOULD LEAVE PART B BLANK.

PART B - Application to vary a premises licence under the Licensing Act 2003

I Timothy Graham Sleeman, being the proposed premises licence holder of an existing licence to be converted under the terms of Schedule 8 to the Licensing Act 2003 apply to vary it under section 34 of the Licensing Act 2003 (delete as applicable) for the premises described in Part A above.

Part B1 - Variation

Do you want the proposed variation to have effect from the second appointed day?

Day Month Year

If not do you want the variation to take effect from N/A

If your proposed variation would mean that 5,000 or more people are expected to attend the premises at any one time, please state the number expected to attend

Please describe briefly the nature of the proposed variation. (Please read guidance note 8)

1. To permit regulated entertainment comprising: Live music and amplified voice, recorded music by juke box and music systems, comperes for functions and quizzes and similar forms of entertainment, indoor pub games comprising a sporting event in the presence of an audience, exhibition of a film principally video entertainment on screens and TV screens and amusement machines.
2. To the extent that the variation in paragraph 4 is not granted or does not permit: to permit sale of alcohol and such regulated entertainment until 01.00 the following morning on Friday, Saturday, Sunday and Monday at bank holiday weekends, Christmas Eve, Boxing Day and also to the extent that the variation in paragraph 4 is not granted to open to the same hour on up to 20 occasions per annum at my discretion upon 7 days prior notice to the police (if required by them).
3. To permit the premises to open for licensable activities to show the broadcast of televised sporting events of national or international interest outside normal operating hours as identified in box M such opening times for this purpose to be confirmed upon 7 days prior notice in writing to the police before the premises intend to open, such notification to include the opening times and the sporting event which is to be shown.
4. To allow the sale of alcohol and such regulated entertainment as specified in the appropriate boxes below.
5. To permit provision of refreshment after 23:00
6. To remove all embedded restrictions under LA 1964, Children and Young Persons Act 1933, Cinematograph (Safety) Regulations 1955 and Sporting Events (Control of Alcohol etc) Act 1985.

Part B2 - Operating Schedule

Please complete those parts of the operating schedule which would be subject to change if this application to vary were successful.

What licensable activities do you now intend to conduct on the premises and/or at what varied times do you intend to conduct them?

(please see section 1 of the Licensing Act 2003 and Schedule 1 to the Licensing Act 2003)

Provision of regulated entertainment

Yes

- a) plays (if ticking yes, fill in box A)
- b) films (if ticking yes, fill in box B)
- c) indoor sporting events (if ticking yes, fill in box C)
- d) boxing or wrestling entertainment (if ticking yes, fill in box D)
- e) live music (if ticking yes, fill in box E)
- f) recorded music (if ticking yes, fill in box F)
- g) performances of dance (if ticking yes, fill in box G)
- h) anything of a similar description to that falling within (e), (f) or (g) (if ticking yes, fill in box H)

Provision of entertainment facilities for:

- i) making music (if ticking yes, fill in box I)
- j) dancing (if ticking yes, fill in box J)
- k) entertainment of a similar description to that falling within (i) or (j) (if ticking yes, fill in box K)

Provision of late night refreshment (if ticking yes, fill in box L)

Sale by retail of alcohol (if ticking yes, fill in box M)

~~Please complete Part B3 on this form.~~

A

Plays Standard days and timings (please read guidance note 8)			Will the performance of a play take place indoors or outdoors or both – please tick {Y} (please read guidance note 9).	Indoors	
Day	Start	Finish		Outdoors	
Mon			Please give further details here (please read guidance note 10) N/A	Both	
Tue					
Wed			State any seasonal variations for performing plays (please read guidance note 11)		
Thur					
Fri					
Sat			Non standard timings. Where you intend to use the premises for the performance of plays at different times to those listed in the column on the left, please list (please read guidance note 12)		
Sun					

B

Films Standard days and timings (please read guidance note 8)	Will the exhibition of films take place indoors or outdoors or both – please tick {Y} (please read guidance note 9).	Indoors	✓
		Outdoors	

Day	Start	Finish		Both
Mon	10:00	01:00	Please give further details here (please read guidance note 10) As stated in B1 above	
Tue	10:00	01:00		
Wed	10:00	01:00	State any seasonal variations for the exhibition of films (please read guidance note 11) N/A – Save as below	
Thur	10:00	01:00		
Fri	10:00	01:00	Non standard timings. Where you intend to use the premises for the exhibition of films at different times to those listed in the column on the left, please list (please read guidance note 12) When hours for sale of alcohol are extended hereunder these hours are also extended (see box M below)	
Sat	10:00	01:00		
Sun	10:00	01:00		

C

Indoor sporting events Standard days and timings (please read guidance note 8)			Please give further details (please read guidance note 10) As stated in B1 above
Day	Start	Finish	
Mon	10:00	01:00	State any seasonal variations for indoor sporting events (please read guidance note 11) N/A – save as below
Tue	10:00	01:00	
Wed	10:00	01:00	Non standard timings. Where you intend to use the premises for indoor sporting events at different times to those listed in the column on the left, please list (please read guidance note 12) When hours for sale of alcohol are extended hereunder these hours are also extended (see box M below)
Thur	10:00	01:00	
Fri	10:00	01:00	
Sat	10:00	01:00	
Sun	10:00	01:00	

D

Boxing or wrestling entertainment Standard days and timings (please read guidance note 8)			Will the boxing or wrestling entertainment take place indoors or outdoors or both – please tick {Y}(please read guidance note 9).	Indoors	
Day	Start	Finish		Outdoors	
Mon			Please give further details here (please read guidance note 10) N/A	Both	
Tue					
Wed			State any seasonal variations for boxing or wrestling entertainment (please read guidance note 11)		
Thur					
Fri			Non standard timings. Where you intend to use the premises for boxing or wrestling entertainment at different times to those listed in the column on the left, please list (please read guidance note 12)		
Sat					

Sun			

E

Live music Standard days and timings (please read guidance note 8)			Will the performance of live music take place indoors or outdoors or both – please tick {Y} (please read guidance note 9).	Indoors	✓
				Outdoors	
				Both	
Day	Start	Finish	Please give further details here (please read guidance note 10) Live music and amplified voice as stated in B1 above		
Mon	10:00	01:00			
Tue	10:00	01:00	State any seasonal variations for the performance of live music (please read guidance note 11) N/A – save as below		
Wed	10:00	01:00			
Thur	10:00	01:00	Non standard timings. Where you intend to use the premises for the performance of live music at different times to those listed in the column on the left, please list (please read guidance note 12) When hours for sale of alcohol are extended hereunder these hours are also extended (see box M below)		
Fri	10:00	01:00			
Sat	10:00	01:00			
Sun	10:00	01:00			

F

Recorded music Standard days and timings (please read guidance note 8)			Will the playing of recorded music take place indoors or outdoors or both – please tick {Y} (please read guidance note 9).	Indoors	✓
				Outdoors	
				Both	
Day	Start	Finish	Please give further details here (please read guidance note 10) Recorded music, including juke box, with or without a DJ, during normal business hours or as part of functions and including audience participation as specified in B1 above.		
Mon	10:00	01:00			
Tue	10:00	01:00	State any seasonal variations for playing recorded music (please read guidance note 11) N/A – save as below		
Wed	10:00	01:00			
Thur	10:00	01:00	Non standard timings. Where you intend to use the premises for the playing of recorded music entertainment at different times to those listed in the column on the left, please list (please read guidance note 12) When hours for sale of alcohol are extended hereunder these hours are also extended (see box M below)		
Fri	10:00	01:00			
Sat	10:00	01:00			
Sun	10:00	01:00			

G

Performances of dance Standard days and timings (please read guidance note 8)			Will the performance of dance take place indoors or outdoors or both – please tick {Y} (please read guidance note 9).	Indoors	✓
				Outdoors	
				Both	
Day	Start	Finish	Please give further details here (please read guidance note 10) As stated in B1 above		
Mon	10:00	01:00			

Tue	10:00	01:00	
Wed	10:00	01:00	State any seasonal variations for the performance of dance (please read guidance note 11) N/A - save as below
Thur	10:00	01:00	
Fri	10:00	01:00	Non standard timings. Where you intend to use the premises for the performance of dance entertainment at different times to those listed in the column on the left, please list (please read guidance note 12) When hours for sale of alcohol are extended hereunder these hours are also extended (see box M below)
Sat	10:00	01:00	
Sun	10:00	01:00	

H

Anything of a similar description to that falling within (e), (f) or (g) Standard days and timings (please read guidance note 8)			Please give a description of the type of entertainment you will be providing	
Day	Start	Finish	Will this entertainment take place indoors or outdoors or both - please tick {Y} (please read guidance note 9).	Indoors
				Outdoors
Mon				Both
Tue			Please give further details here (please read guidance note 10)	
Wed				
Thur			State any seasonal variations for entertainment of a similar description to that falling within (e), (f) or (g) (please read guidance note 11)	
Fri				
Sat			Non standard timings. Where you intend to use the premises for the entertainment of similar description to that falling within (e), (f) or (g) at different times to those listed in the column on the left, please list (please read guidance note 12)	
Sun				

I

Provision of facilities for making music. Standard days and timings (please read guidance note 8)			Please give a description of the facilities for making music you will be providing The normal facilities for making music will be on offer as conveniently available and as appropriate for this type of venue	
			Will the facilities for making music be indoors or outdoors or both - please tick {Y} (please read guidance note 9).	Indoors <input checked="" type="checkbox"/>
				Outdoors <input type="checkbox"/>
				Both <input type="checkbox"/>
Day	Start	Finish	Please give further details here (please read guidance note 10) To be used as and when required at any time when the premises are open for the sale of alcohol	
Mon	10:00	01:00		
Tue	10:00	01:00		
Wed	10:00	01:00		
Thur	10:00	01:00		
Fri	10:00	01:00		
Sat	10:00	01:00		
Sun	10:00	01:00		
			State any seasonal variations for the provision of facilities for making music (please read guidance note 11) N/A - save as below	
			Non standard timings. Where you intend to use the premises for provision of facilities for making music entertainment at different times to those listed in the column on the left, please list (please read guidance note 12) When hours for sale of alcohol are extended hereunder these hours are also extended (see box M below)	

J

Provision of facilities for dancing Standard days and timings (please read guidance note 1)			Will the facilities for dancing be indoors or outdoors or both - please tick {Y} (see guidance note 9).	
				Indoors <input checked="" type="checkbox"/>
				Outdoors <input type="checkbox"/>
				Both <input type="checkbox"/>
Day	Start	Finish	Please give further details here (please read guidance note 10) To be used as and when required at any time when the premises are open for the sale of alcohol	
Mon	10:00	01:00		
Tue	10:00	01:00		
Wed	10:00	01:00		
Thur	10:00	01:00		
Fri	10:00	01:00		
Sat	10:00	01:00		
Sun	10:00	01:00		
			State any seasonal variations for providing dancing facilities (please read guidance note 11) N/A - save as below	
			Non standard timings. Where you intend to use the premises for the provision of facilities for dancing entertainment at different times to those listed in the column on the left, please list (please read guidance note 12) When hours for sale of alcohol are extended hereunder these hours are also extended (see box M below)	

K

Provision of facilities for entertainment of a similar description to that falling within I or J Standard days and timings (please read guidance note 8)			Please give a description of the type of entertainment facility you will be providing	
Day	Start	Finish	Will the entertainment facility be indoors or outdoors	Indoor

			or both – please tick {Y} (please read guidance note 9).	Outdoor
Mon				Both
Tue			Please give further details here (please read guidance note 10)	
Wed				
Thur			State any seasonal variations for the provision of facilities for entertainment of a similar description to that falling within J or K (please read guidance note 11)	
Fri				
Sat			Non standard timings. Where you intend to use the premises for the provision of facilities for entertainment of a similar description to that falling within J or K at different times to those listed in the column on the left, please list (please read guidance note 12)	
Sun				

L

Late night refreshment Standard days and timings (please read guidance note 8)			Will the provision of late night refreshment take place indoors or outdoors or both – please tick {Y} (please read guidance note 9).	Indoors	✓
				Outdoors	
				Both	
Day	Start	Finish	Please give further details here (please read guidance note 10) As stated in B1 above		
Mon	23:00	01:00			
Tue	23:00	01:00			
Wed	23:00	01:00	State any seasonal variations for the provision of late night refreshment (please read guidance note 11) N/A – save as below		
Thur	23:00	01:00			
Fri	23:00	01:00	Non standard timings. Where you intend to use the premises for the provision of late night entertainment at different times, to those listed in the column on the left, please list (please read guidance note 12) When hours for sale of alcohol are extended hereunder these hours are also extended (see box M below)		
Sat	23:00	01:00			
Sun	23:00	01:00			

M

Supply of alcohol Standard days and timings (please read guidance note 8)			Will the supply of alcohol be for consumption (Please tick box Y) (please read guidance note 13)	On the premises	
Day	Start	Finish		Off the premises	
Mon	10:00	01:00	State any seasonal variations for the supply of alcohol (please read guidance note 11)	Both	✓
Tue	10:00	01:00			
Wed	10:00	01:00			
Thur	10:00	01:00			
Fri	10:00	01:00			
Sat	10:00	01:00			
Sun	10:00	01:00			
			Non-standard timings. Where you intend to use the premises for the supply of alcohol at different times to those listed in the column on the left, please list (please read guidance note 12)		
			To the extent that the variation in part B1 paragraph 4 is not granted or does not permit: to permit sale of alcohol and such regulated entertainment as authorised hereunder until 01.00 on Friday, Saturday, Sunday and Monday at bank holiday weekends, Christmas Eve, Boxing Day and also to the extent that the variation in part B1 paragraph 4 is not granted to open to the same hour on up to 20 occasions per annum at my discretion upon 7 days prior notice to the police (if required by them).		
			New Years Eve: 10:00 to New Years Day – terminal hour as proposed		
			To permit the premises to open for licensable activities to show the broadcast of televised sporting events of national or international interest outside normal operating hours such opening times for this purpose to be confirmed upon 7 days prior notice in writing to the police before the premises intend to open, such notification to include the opening times and the sporting event which is to be shown.		

IN ALL CASES PLEASE COMPLETE BOXES N, O, P and Q below

N

Please highlight any adult entertainment or services, activities, other entertainment or matters ancillary to the use of the premises that may give rise to concern in respect of children (please read guidance note 14)
NONE save for the presence of AWP machines already authorised the use of which is not permitted by persons under the age of 18

O

Hours premises are open to the public. Standard days and timings (please read guidance note 8)			State any seasonal variation (please read guidance note 11) Please see box M above
Day	Start	Finish	
Mon	10:00	01:30	
Tue	10:00	01:30	
Wed	10:00	01:30	
Thur	10:00	01:30	
Fri	10:00	01:30	
Sat	10:00	01:30	
Sun	10:00	01:30	

Non standard timings. Where you intend to use the premises to be open to the public at different times from those listed in the column on the left, please list (please read guidance note 12)

The premises will close 30 minutes after the end of the non-standard timings identified in box M above.

P

Please identify any of the conditions, terms or restrictions currently imposed on the converted licence which you believe could be removed as a consequence of the proposed variation you are seeking

Removal of all embedded restrictions inherent in Licensing Act 1964, save as specified elsewhere in part B of this application.

Q Please describe any additional steps that you intend to take in order to promote the four licensing objectives-if the proposed variation is granted:

a) General – all four licensing objectives (b,c,d,e) (please read guidance note 15)

I have undertaken my own risk assessment to take the following proposed steps.

The types of regulated entertainment proposed materially do no more than reinstate the normal pub entertainment that was previously unregulated as identified in B1 above.

No new steps have been identified in relation to the four licensing objectives save as below.

b) The prevention of crime and disorder

No further risks have been identified which need to be addressed, save as below

1. Any person exercising a security activity (as defined by paragraph 2(1)(a) of schedule 2 of the Private Security Industry Act 2001) shall be licensed by the Security Industry Authority.
2. Such a person will be employed at the premises at the discretion of the designated premises supervisor/holder of the Premises Licence.
3. Any person as defined in condition (1) will clearly display his name badge at all times whilst on duty.
4. No customers apparently carrying open bottles upon entry shall be admitted to the premises at any times the premises are open to the public.
5. Where CCTV is installed with recording facilities such recordings shall be retained for a period of 30 days and made available within a reasonable time upon request by the police.
6. Alcoholic and other drinks may not be removed from the premises in open containers save for consumption in any external area provided for that purpose.

c) Public safety

No further risks have been identified which need to be addressed, save as below

1. To comply with the reasonable requirements of the fire officer from time to time.
2. To comply with the reasonable requirements of the building control officer.

d) The prevention of public nuisance

No further risks have been identified which need to be addressed, save as below

1. Where appropriate, prominent, clear and legible notices shall be displayed at all exits requesting the public respect the needs of local residents and to leave the premises and area quietly.
2. Noise or vibration shall not emanate from the premises so as to cause a nuisance to nearby properties.

e) The protection of children from harm

The restrictions set out in the Licensing Act 2003 will apply. No unusual or additional risks of harm to children have been identified.

No films or videos of any description will be shown so that they can be viewed by persons under the age of any applicable BBFC/Local Authority certification.

Children under the age of 16 shall not be permitted to enter the premises after 21.00

Part B3 - Premises Supervisor

Full name of proposed designated premises supervisor

Timothy Graham Sleeman

Address of proposed designated premises supervisor

Black Horse, Long Lane, Heath Charnock, Chorley, PR6 9EE

Personal licence number of proposed designated supervisor, if any, and issuing authority of the personal licence, if applicable
N/A

Please tick ✓

- I enclose the consent form completed by the proposed premises supervisor
- I will give a copy of Part B3 of this application to the chief officer of police (section 37 of the Licensing Act 2003)
- I have sent copies of this application to vary (except Part B3) to responsible authorities and others where applicable (section 34 of the Licensing Act 2003)
- I understand that I must now advertise my application to vary (section 37 of the Licensing Act 2003)
- I understand that if I do not comply with the above requirements my application will be rejected

Part B4 – Signatures (please read guidance note 16)

Signature of applicant (the proposed current premises licence holder) or applicant’s solicitor or other duly authorised agent. (See guidance note 17) **If signing on behalf of the applicant please state in what capacity.**

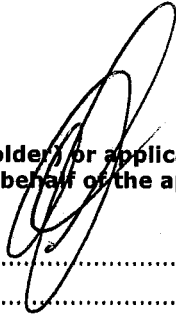
Signature: John Gaunt & Partners 

Date 26th July 2005

Capacity: Solicitors.....

Where the premises licence is jointly held signature of 2nd applicant (the proposed current premises licence holder) or 2nd applicant’s solicitor or other authorised agent. (please read guidance note 18). **If signing on behalf of the applicant please state in what capacity.**

Signature:

Date

Capacity.....

Contact name (where not previously given) and address for correspondence associated with this application (please read guidance note 19) John Gaunt & Partners Omega Court 372 Cemetery Road	
Post town Sheffield	Post code S11 8FT

Notes for Guidance

PART A

1. Describe the premises. For example the type of premises, its general situation and layout and any other information which would be relevant to the licensing objectives. Where your application includes off-supplies of alcohol and provide a place for consumption of these off-supplies you must include a description of where the place is and its proximity to the premises.
2. Where the conditions to which your existing licence(s) is granted do not relate solely to any one of the four licensing objectives, please describe such conditions in the general box.
3. The law requires you to send a mandatory copy of this application to the chief officer of police for that area at the same time as sending to the relevant licensing authority.
4. The application form must be signed.
5. An applicant’s agent (for example solicitor) may sign the form on their behalf provided that they have actual authority to do so.
6. Where there is more than one applicant, both applicants or their respective agents must sign the application form.
7. This is the address we shall use to correspond with you about this application.

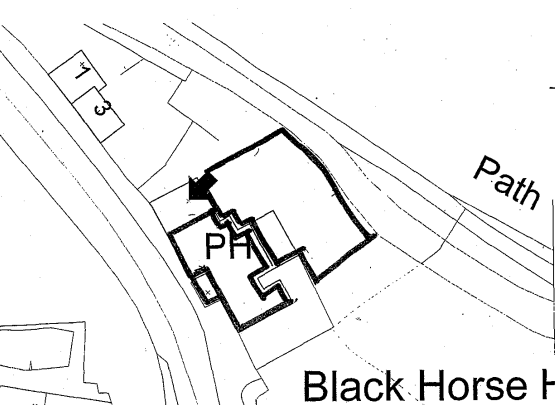

Black Horse Inn

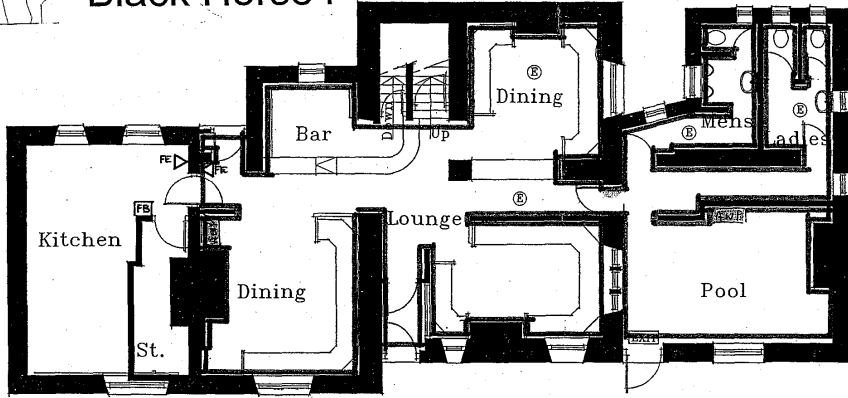

- Fire Extinguisher**
- Each step shown is 175mm in height
 - All existing fire fighting & other safety equipment to be retained

KEY TO SYMBOLS

- Ⓢ EMERGENCY LIGHTING
- Ⓢ SMOKE DETECTOR
- Ⓢ BREAK GLASS POINT
- EXIT ILLUMINATED EXIT SIGNS
- ☞ SOUNDER
- MAX. RISER OF STEPS = 175mm
- EXISTING LICENCED AREA
- PROPOSED ALTERATIONS
- A.W.P.
- ∇ FE FIRE EXTINGUISHER
- FB FIRE BLANKET

CLIENT			
TRUST INNS LIMITED BLENHEIM HOUSE, ACKHURST PARK, CHORLEY.			
PROJECT			
Black Horse Long Lane Chorley			
TITLE			
Ground Floor Plan			
SCALE	DATE	DRAWN	DRAWING No.
1:100	01.02.05		016

A. J. LANG
Architectural and Surveying Services
The Old School House,
Farnworth,
Prescot,
Merseyside,
L35 4DA.
Tel/Fax: (01772) 455175
Mobile: 07970 639772

TRANSFERS

of the within-mentioned Justices' Licence

At the Transfer Sessions (~~General Annual Licensing Meeting~~) holden at the Court House, St. Thomas's Square, Chorley, on the 7th day of APRIL 19007, for the Division of Chorley in the County of Lancaster.

The Licensing Justices for the said Division hereby grant to TIMOTHY GRAHAM SLEEMAN (hereinafter called the licensee) of _____ a justices' licence by way of transfer of the licence within contained in substitution for the last mentioned licensee, and the licence so granted shall have effect from this day until the fourth day of April, 19007.

Given under the official stamp of the Licensing Justices, which is hereto affixed under their authority by me,

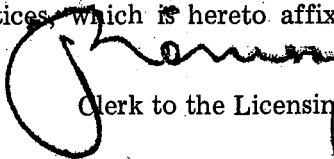
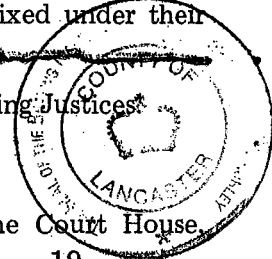
Clerk to the Licensing Justices

At the Transfer Sessions (General Annual Licensing Meeting) holden at the Court House, St. Thomas's Square, Chorley, on the _____ day of _____ 19____, for the Division of Chorley in the County of Lancaster.

The Licensing Justices for the said Division hereby grant to _____ (hereinafter called the licensee) of _____ a justices' licence by way of transfer of the licence within contained in substitution for the last mentioned licensee, and the licence so granted shall have effect from this day until the fourth day of April, 19____.

Given under the official stamp of the Licensing Justices, which is hereto affixed under their authority by me,

Clerk to the Licensing Justices.

PROTECTION ORDERS

Before the Magistrates' Court for the Division above mentioned sitting at the Court House, St. Thomas's Square, Chorley, on the _____ day of _____ 19____.

The said Court, being satisfied that _____ of _____ is a person to whom the licensing justices could grant a transfer of the within written licence, hereby grant to him the same authority as that conferred by the said licence upon the holder thereof until the conclusion of the second licensing sessions begun after the date hereof unless such licence shall be sooner transferred or removed.

Given under the official stamp of the Court, which is hereby verified by me.

Clerk to the Justices.

Before the Magistrates' Court for the Division above mentioned sitting at the Court House, St. Thomas's Square, Chorley, on the _____ day of _____ 19____.

The said Court, being satisfied that _____ of _____ is a person to whom the licensing justices could grant a transfer of the within written licence, hereby grant to him the same authority as that conferred by the said licence upon the holder thereof until the conclusion of the second licensing sessions begun after the date hereof unless such licence shall be sooner transferred or removed.

Given under the official stamp of the Court, which is hereby verified by me.

RENEWALS

of the within-mentioned Justices' Licence.

At the General Annual Licensing Meeting holden at the Court House, St. Thomas's Square, Chorley, on the 7th Feb 2001 for the Division of Chorley, in the County of Lancaster.

The Licensing Justices for the said Division hereby grant a justices' licence by way of renewal of the licence within contained, and the licence so granted shall be in force until the fourth day of April, 19 2004

Given under the official stamp of the Licensing Justices, which is hereto affixed under their authority by me,

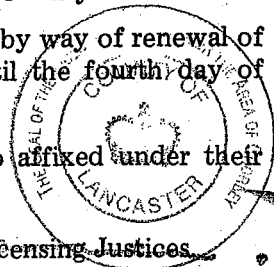

Clerk to the Licensing Justices.



At the General Annual Licensing Meeting holden at the Court House, St. Thomas's Square, Chorley, on the 04/02/04 for the Division of Chorley, in the County of Lancaster.

The Licensing Justices for the said Division hereby grant a justices' licence by way of renewal of the licence within contained, and the licence so granted shall be in force until the fourth day of April, 19 2007

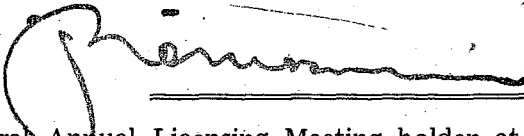
Given under the official stamp of the Licensing Justices, which is hereto affixed under their authority by me,

Clerk to the Licensing Justices.

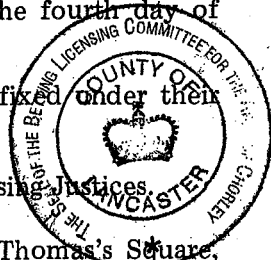

At the General Annual Licensing Meeting holden at the Court House, St. Thomas's Square, Chorley, on the _____ for the Division of Chorley, in the County of Lancaster.

The Licensing Justices for the said Division hereby grant a justices' licence by way of renewal of the licence within contained, and the licence so granted shall be in force until the fourth day of April, 19 _____

Given under the official stamp of the Licensing Justices, which is hereto affixed under their authority by me,

Clerk to the Licensing Justices.

At the General Annual Licensing Meeting holden at the Court House, St. Thomas's Square, Chorley, on the _____ for the Division of Chorley, in the County of Lancaster.

The Licensing Justices for the said Division hereby grant a justices' licence by way of renewal of the licence within contained, and the licence so granted shall be in force until the fourth day of April, 19 _____

Given under the official stamp of the Licensing Justices, which is hereto affixed under their authority by me,

Clerk to the Licensing Justices.

At the General Annual Licensing Meeting holden at the Court House, St. Thomas's Square, Chorley, on the _____ for the Division of Chorley, in the County of Lancaster.

The Licensing Justices for the said Division hereby grant a justices' licence by way of renewal of the licence within contained, and the licence so granted shall be in force until the fourth day of April, 19 _____

Given under the official stamp of the Licensing Justices, which is hereto affixed under their authority by me,

Clerk to the Licensing Justices.

At the General Annual Licensing Meeting holden at the Court House, St. Thomas's Square, Chorley, on the _____ for the Division of Chorley, in the County of Lancaster.

The Licensing Justices for the said Division hereby grant a justices' licence by way of renewal of the licence within contained, and the licence so granted shall be in force until the fourth day of April, 19 _____

Given under the official stamp of the Licensing Justices, which is hereto affixed under their authority by me,

RENEWALS

of the within-mentioned Justices' Licence.

At the General Annual Licensing Meeting holden at the Court House, St. Thomas's Square, Chorley, on the 4/2/98 for the Division of Chorley, in the County of Lancaster.

The Licensing Justices for the said Division hereby grant a justices' licence by way of renewal of the licence within contained, and the licence so granted shall be in force until the fourth day of April, 19 2001

Given under the official stamp of the Licensing Justices, which is hereto affixed under their authority by me,

Clerk to the Licensing Justices.

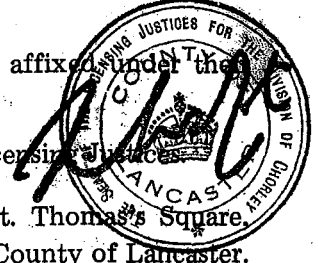

At the General Annual Licensing Meeting holden at the Court House, St. Thomas's Square, Chorley, on the for the Division of Chorley, in the County of Lancaster.

The Licensing Justices for the said Division hereby grant a justices' licence by way of renewal of the licence within contained, and the licence so granted shall be in force until the fourth day of April, 19

Given under the official stamp of the Licensing Justices, which is hereto affixed under their authority by me,

Clerk to the Licensing Justices.

At the General Annual Licensing Meeting holden at the Court House, St. Thomas's Square, Chorley, on the for the Division of Chorley, in the County of Lancaster.

The Licensing Justices for the said Division hereby grant a justices' licence by way of renewal of the licence within contained, and the licence so granted shall be in force until the fourth day of April, 19

Given under the official stamp of the Licensing Justices, which is hereto affixed under their authority by me,

Clerk to the Licensing Justices.

At the General Annual Licensing Meeting holden at the Court House, St. Thomas's Square, Chorley, on the for the Division of Chorley, in the County of Lancaster.

The Licensing Justices for the said Division hereby grant a justices' licence by way of renewal of the licence within contained, and the licence so granted shall be in force until the fourth day of April, 19

Given under the official stamp of the Licensing Justices, which is hereto affixed under their authority by me,

Clerk to the Licensing Justices.

At the General Annual Licensing Meeting holden at the Court House, St. Thomas's Square, Chorley, on the for the Division of Chorley, in the County of Lancaster.

The Licensing Justices for the said Division hereby grant a justices' licence by way of renewal of the licence within contained, and the licence so granted shall be in force until the fourth day of April, 19

Given under the official stamp of the Licensing Justices, which is hereto affixed under their authority by me,

Clerk to the Licensing Justices.

At the General Annual Licensing Meeting holden at the Court House, St. Thomas's Square, Chorley, on the for the Division of Chorley, in the County of Lancaster.

The Licensing Justices for the said Division hereby grant a justices' licence by way of renewal of the licence within contained, and the licence so granted shall be in force until the fourth day of April, 19

Given under the official stamp of the Licensing Justices, which is hereto affixed under their