



1. The owner shall be responsible for the design and construction of the proposed development in accordance with the approved plans and specifications. The drawings are the property of the Council and shall not be reproduced, copied, altered or used in any way without the prior written consent of the Council. The Council shall not be liable for any loss or damage, including consequential loss or damage, arising from the use of the drawings or the information contained therein. The Council shall not be responsible for any errors or omissions in the drawings or the information contained therein. The Council shall not be responsible for any loss or damage, including consequential loss or damage, arising from the use of the drawings or the information contained therein.

 	
Project Name 05/00455/FULMAJ	Client Name Fulmer
Project No. 1003	Date 28/11/05
Drawing No. 210	Scale 1:500
Drawing Title Planning	Drawing No. 210

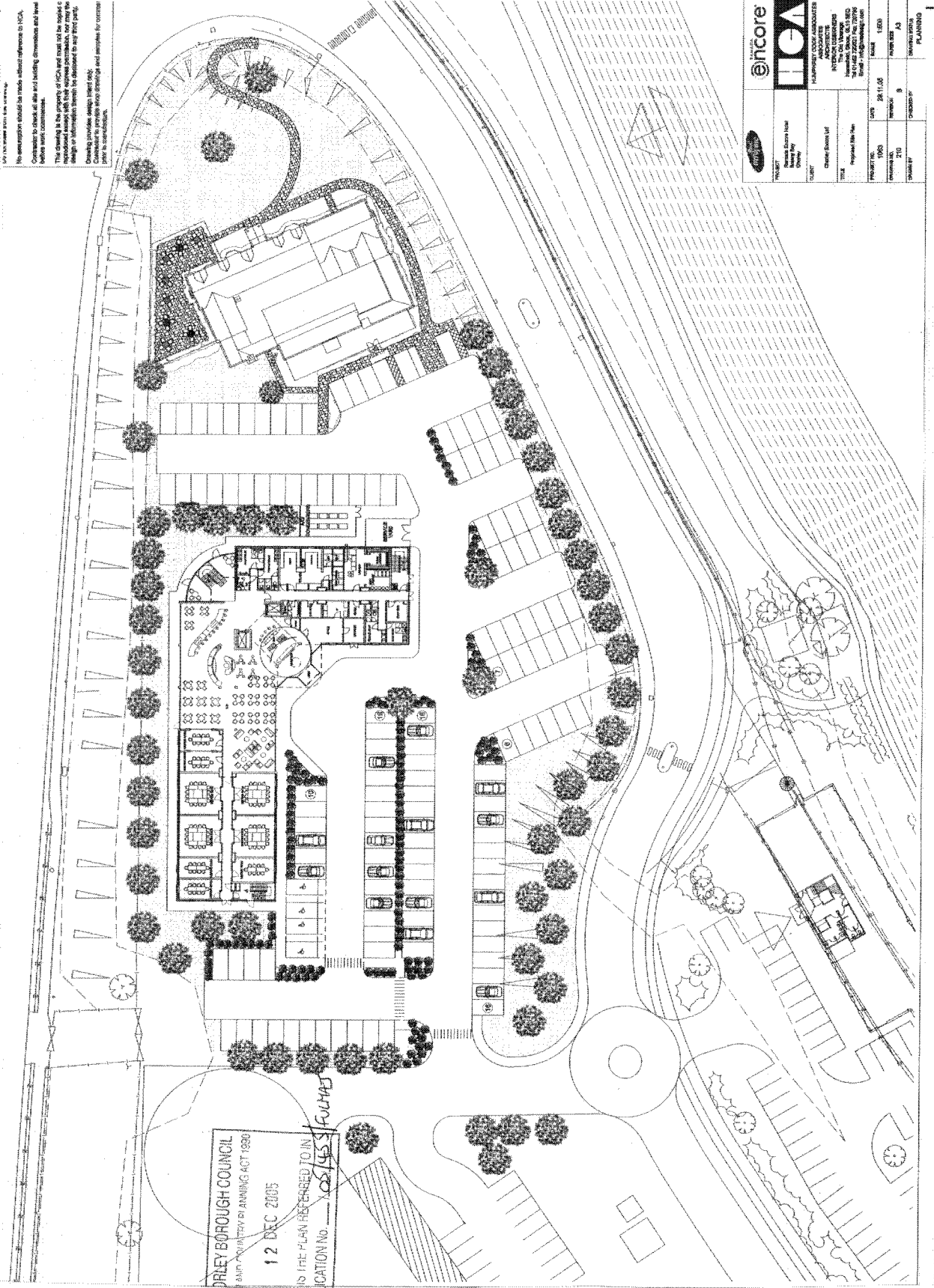

CHORLEY BOROUGH COUNCIL  
 (AN ACT OF PARLIAMENT 1972)  
 12 DEC 2005  
 THIS PLAN REFERRED TO IN  
 APPLICATION NO. 05/00455/FULMAJ

Jane E Meek BSc(Hons) DipTP MRTPI Head of Development and Regeneration Chorley Borough Council		Reproduced from the Ordnance Survey mapping with the permission of the Controller of Her Majesty's Stationery Office. Crown Copyright. Unauthorised reproduction infringes Crown Copyright and may lead to prosecution or civil proceedings. Chorley B.C. 100018509	
Application Number: <b>05/00455/FULMAJ</b>	Grid Ref: <b>E: 358977</b> <b>N: 419512</b>	Scale: <b>1:1</b>	Agenda Item No. <b>A. 2</b>