

26-submission dated 17-1-18
Proposed stables at Gorton's Farm

M
SD
LOCATION MAP

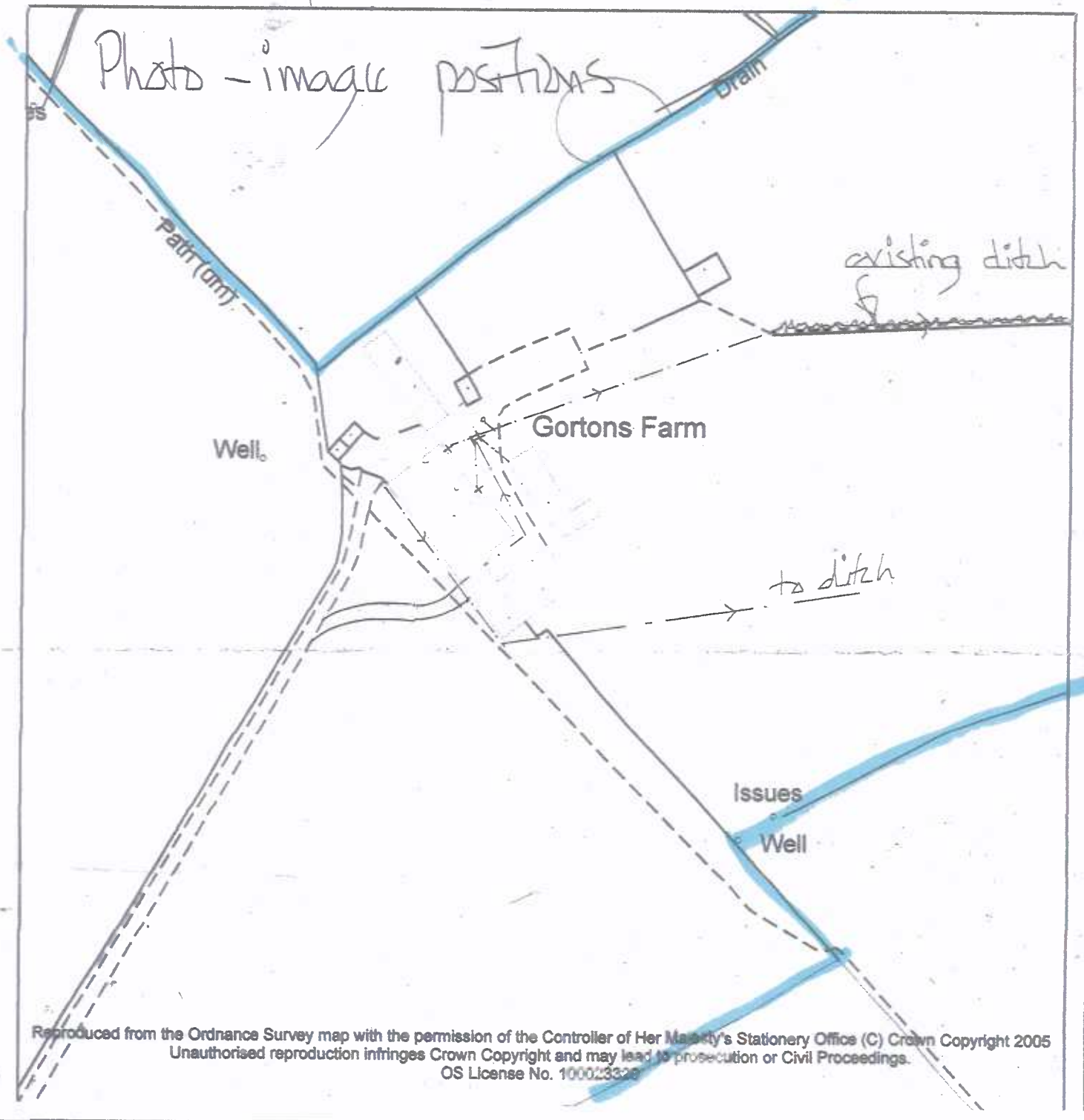

t of gorton's Farm site exiting onto Bury Lane., Withnell, nr

Reproduced from the Ordnance Survey map with the permission of the Controller of Her Majesty's Stationary Office (C) Crown Copyright 2005
Unauthorised reproduction infringes Crown Copyright and may lead to prosecution or Civil Proceedings.
OS License No. 100023328

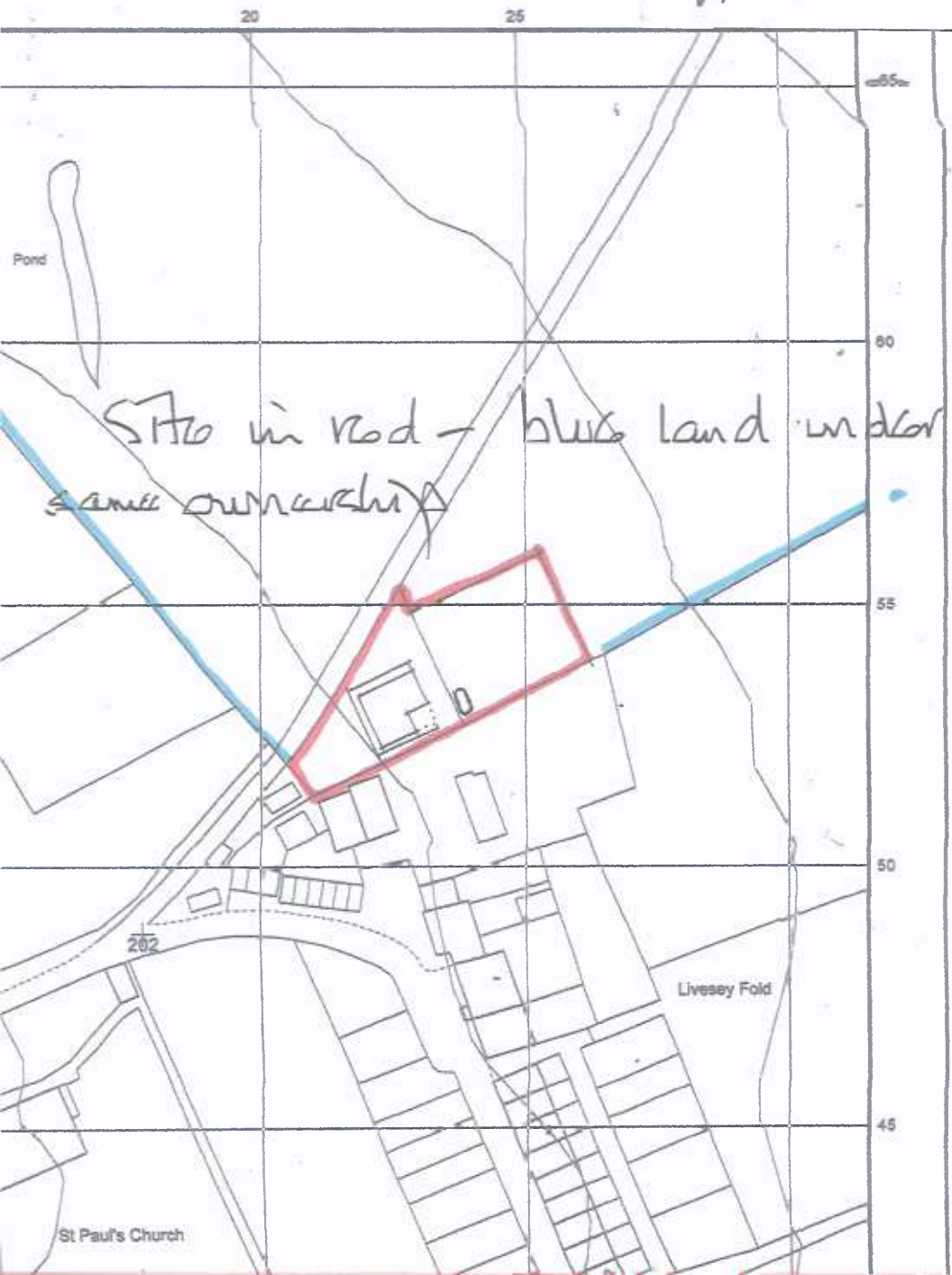

P.P. - 066 74725

Re-submission dated 17-1-18

Proposed Stables at Gorton's Farm

M
SD
LOCATION MAP

